



This Drawing Must Be Read in Conjunction with the Associated Arboricultural Report

This Drawing is Copyright - © The Tree File Ltd 2021

Clonliffe Tree Impacts Plan NE 1/1 Scale 1:500 @ A1

This is a colour coded drawing that will be difficult or impossible to interpret if reproduced in black and white

Ashgrove House
26 Foxrock Park
Dublin 18



Mob. 086-3819011
e-mail - thetreefile@eircom.net

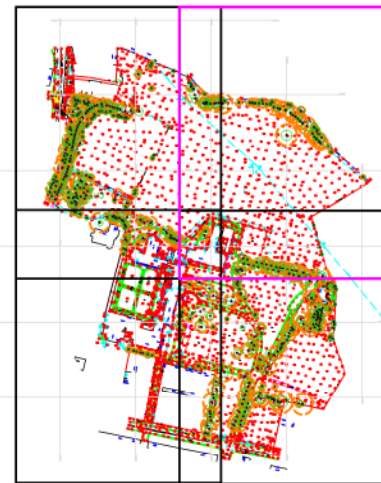

Colour Coding of Tree Impacts

- Trees Intended for Retention - Solid Green Crown Outline
- Trees Intended for Removal In Conjunction With Development Works - Broken Pink Crown Outline

Colour Coding of Tree Categories

- Category "A" Trees (Green Button)
- Category "B" Trees (Blue Button)
- Category "C" Trees (Gray Button)
- Category "U" Trees (Red Button)

Graphic Representation of Tree and Protection Zone

- Canopy Extent
- Cardinal Radii
- Category Code
- Stem Circumference
- Canopy is drawn to account for any natural asymmetry or imbalance. Crown Representation is scaled to account for north, east, west and south radii.
- Root Protection Area (RPA)
- This area relates the "RPA" radius as defined in the Tree Survey Table and is measured from the tree centre.
- This area defines the preliminary Construction Exclusion Zone (CEZ) that must be protected by fencing from the potentially damaging affects of construction activity.

Client: CWTC Multi Family ICAV acting on behalf of its sub-fund DBTR DRI Fund
Scale: 1:500 Date: April 2021
Project: Tree Survey, Holy Cross College, Clonliffe Road, Dublin 3 and Drumcondra Road Lower, Drumcondra, Dublin 9
Description: Tree Impacts Plan
Drawing Title: Clonliffe Tree Impacts Plan NE